

Creating a continuous uninterrupted line of beautiful, glare-free LED light, the ELEMENT Merge recessed linear system inconspicuously puts light where it is needed without drawing attention to the fixture. The ELEMENT Merge Gimbal Spot head option allows you to simply twist-and-lock LED adjustable spot heads anywhere along the low-voltage bus channel for stunning design flexibility. The Merge Gimbal Spot does not break the ceiling plane for a smooth overall appearance. Options for beam spread, mounting, and color temperature allow designers to specify a system tailored to exacting demands.

**Key features**

- Gimbal Spot Head mounts within the Merge linear channel, does not break the ceiling plane.
- Twist-and-lock design allows LED adjustable spot heads to be placed anywhere along the bus channel
- 3-Step color binning or better

**SPECIFICATIONS**

|                         |  |
|-------------------------|--|
| DELIVERED LUMENS        | 836 (80CRI, 3500K)   |
| WATTS                   | 9.3  |
| EFFICACY                | 90 l/w   |
| CRI                     | 80+ & 90+  |
| CBCP (40°)              | 1472   |
| CCT OPTIONS             | 2700K, 3000K, 3500K  |
| VOLTAGE                 | 120V or 277V (Concealed 10 gauge, low-voltage bus bar, order 12-volt remote transformer sold separately) |
| DIMMING                 | ELV, 0-10V, MLV. Dimming dependant on transformer (see grid for details)                                 |
| FIELD CHANGEABLE OPTICS | 20°, 30°, 40°, 60°   |
| ADJUSTABILITY           | 40° tilt, 360° rotation  |
| POWER SUPPLY            | 12VAC  |
| LED LIFETIME            | L70; 50,000 hours  |
| WARRANTY*               | 5 years  |



\*Visit [techlighting.com](http://techlighting.com) for specific warranty limitations and details.  
 Maximum number of spots is variable depending on the length of the housing panel;  
 1 spot per foot of housing panel.  
 Max run length is 80' for the channel; typical max run length is 40' for the low-voltage bus which can be powered from both sides for a total of 80'; system wattage will impact max run length

## DIMENSIONS

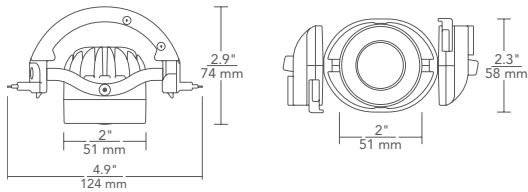

Gimbal Spot

## GRIDS

### SPOT HEAD\*

| SYSTEM | TYPE     | CRI / COLOR TEMPERATURE  | BEAM SPREAD  | FINISH               |
|--------|----------|--------------------------|--------------|----------------------|
| RLS3   | G GIMBAL | <b>827</b> 80 CRI, 2700K | <b>2</b> 20° | <b>W</b> MATTE WHITE |
|        |          | <b>830</b> 80 CRI, 3000K | <b>3</b> 30° |                      |
|        |          | <b>835</b> 80 CRI, 3500K | <b>4</b> 40° |                      |
|        |          | <b>927</b> 90 CRI, 2700K | <b>6</b> 60° |                      |
|        |          | <b>930</b> 90 CRI, 3000K |              |                      |
|        |          | <b>935</b> 90 CRI, 3500K |              |                      |
| RSL3   | G        |                          |              | W                    |

\*TRANSFORMER REQUIRED

### LENSES/LOUVERS

|     | TYPE   |                       |
|-----|--------|-----------------------|
| MOC | GG     | PLAIN GLASS           |
|     | SF     | SOFT FOCUS            |
|     | LL     | LINEAR SPREAD         |
|     | EC     | EGGCRATE LOUVER       |
|     | LS1-W  | 1" LONG SNOOT WHITE   |
|     | LS12-W | 1/2" LONG SNOOT WHITE |
| MOC |        |                       |

### REPLACEMENT OPTICS

|              | BEAM SPREAD   |
|--------------|---------------|
| 351LEDGATOPT | <b>20</b> 20° |
|              | <b>30</b> 30° |
|              | <b>40</b> 40° |
|              | <b>60</b> 60° |
| 351LEDGATOPT |               |

### TRANSFORMERS\* (ORDERED SEPARATELY)

| ITEM           | DESCRIPTION            | DIMMING  |
|----------------|------------------------|----------|
| 700AT060EL     | ELECTRONIC, 60W, 120V  | ELV      |
| 700AT152EL     | ELECTRONIC, 150W, 120V | ELV      |
| 700AT152ELD010 | ELECTRONIC, 150W, 120V | 0-10V    |
| 700AT150T      | MAGNETIC, 150W, 120V   | MAGNETIC |
| 700AT150T277   | MAGNETIC, 150W, 277V   | MAGNETIC |
| 700AT302EL     | ELECTRONIC, 300W, 120V | ELV      |
| 700AT300T      | MAGNETIC, 300W, 120V   | MAGNETIC |
| 700AT300T277   | MAGNETIC, 300W, 277V   | MAGNETIC |

DO NOT LOAD TRANSFORMER ABOVE 70% OF RATED LOAD DUE TO IN-RUSH CURRENT. \*CONSULT SPEC SHEETS FOR DIMENSIONS.

## PROJECT INFO

| FIXTURE TYPE & QUANTITY | JOB NAME & INFO | NOTES |
|-------------------------|-----------------|-------|
|                         |                 |       |
|                         |                 |       |

**ELEMENT**  
by Tech Lighting®

GENERATION BRANDS  
7400 Linder Avenue, Skokie, Illinois 60077  
T 847.410.4400 F 847.410.4500



© 2017 Tech Lighting, L.L.C. All rights reserved. The "Tech Lighting" graphic is a registered trademark of Tech Lighting, L.L.C. Tech Lighting reserves the right to change specifications for product improvements without notification.

## PHOTOMETRICS: MERGE

DESCRIPTION: Merge LED Gimbal Spot  
40° Optic, 80 CRI, 3500K

MODEL: RLS3G8354W

INPUT POWER (WATTS): 9.3  
 INPUT POWER FACTOR: 0.91  
 ABSOLUTE LUMINOUS FLUX (LUMENS): 8361  
 LUMEN EFFICACY (LUMENS PER WATT): 90

| ANGLE | 0°   | 45°  | 90°  |
|-------|------|------|------|
| 0°    | 1742 | 1742 | 1742 |
| 5°    | 1679 | 1679 | 1690 |
| 10°   | 1509 | 1512 | 1523 |
| 15°   | 1244 | 1234 | 1240 |
| 20°   | 868  | 858  | 883  |
| 25°   | 510  | 506  | 518  |
| 30°   | 246  | 252  | 268  |
| 35°   | 117  | 120  | 126  |
| 40°   | 56   | 60   | 62   |
| 45°   | 30   | 32   | 33   |
| 50°   | 19   | 19   | 20   |
| 55°   | 13   | 13   | 14   |
| 60°   | 9    | 9    | 10   |
| 65°   | 6    | 7    | 7    |
| 70°   | 4    | 4    | 4    |
| 75°   | 3    | 3    | 3    |
| 80°   | 1    | 1    | 1    |
| 85°   | 0    | 0    | 0    |
| 90°   | 0    | 0    | 0    |

