

Creating a continuous uninterrupted line of beautiful, glare-free LED light, the ELEMENT Merge 1.5 recessed linear system inconspicuously puts light where it is needed without drawing attention to the fixture. The continuous line aesthetic created by the ELEMENT Merge 1.5 system is enhanced using either a specifically engineered 90° turn connector or wall-to-ceiling connector. Lines of LED light can be designed to seamlessly make 90° same-plane turns or transition from ceiling to wall for enhanced design interest while also allowing the option to add spot heads for accent and task lighting, all without adding more light fixtures to the space.

## Key features

- Seamlessly makes wall-to-ceiling transitions for enhanced design
- Low profile design for use in 2x4 construction
- Dual sided illumination for even light along the channel
- 3-Step or better color binning
- Internal reflector finished with high-reflectance matte white paint for even light distribution & optimal efficiency

## SPECIFICATIONS

DELIVERED LUMENS	900 lms/ft or 600 lms/ft
WATTS	15 watts/ft or 9 watts/ft
EFFICACY	60 l/w or 67 l/w
CRI	80+, 90+
CCT OPTIONS	2700K, 3000K, 3500K or Warm Color Dimming (3000K-2000K)
VOLTAGE	120V or 277V (Concealed 10 gauge, low-voltage bus bar, order 12-volt remote transformer sold separately)
DIMMING	ELV, 0-10, Hi-Lume
CEILING APPEARANCE	Flanged or Flangeless
CEILING APERTURE	1.5" beveled
HOUSING	IC Airtight. IC suitable up to R60 spray foam insulation (Consult factory for Chicago Plenum).
POWER SUPPLY**	Constant Current (Each linear channel includes a self-contained ELV, 0-10V, Lutron Hi-Lume 2 Wire PWM (120V only) or Lutron Hi-Lume, Eco System Fade-to-Black Driver, 0-10V 1%, 0-10V 0.1%)
CONSTRUCTION	Housing: 20 gauge sheet metal Extrusion: Aluminum
HARDWARE	Steel
FINISH	White Powder Coat
GENERAL LISTING	ETL
CALIFORNIA TITLE 24	Registered CEC Appliance Database. Can be used to comply with CEC 2016 Title 24 Part 6 (Static White, 90 CRI versions).
LED LIFETIME	L70; 50,000 hours
WARRANTY*	5 years

\*Visit ELEMENT-lighting.com for specific warranty limitations and details.

\*\*Consult Quotes Department for additional driver options.

Max run length is 80' for the channel; typical max run length is 40' for the low-voltage bus which can be powered from both sides for a total of 80'; system wattage will impact max run length



MERGE  
shown flangeless

## DIMENSIONS

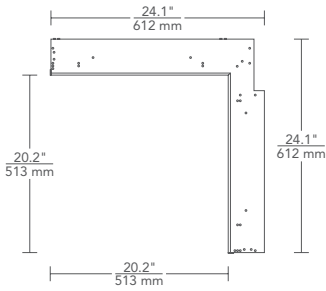

Flanged wall-to-ceiling (side view)

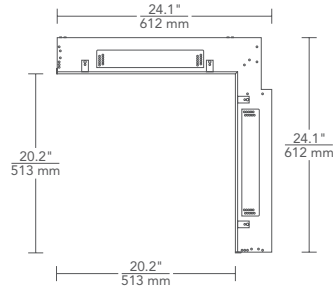

Flangeless wall-to-ceiling (side view)

## GRIDS

### LINEAR CHANNELS

SYSTEM	TYPE	CEILING APPEARANCE	CRI/COLOR TEMPERATURE	FINISH	HOUSING	CONTROLS		
RLS1	WTC WALL-TO-CEILING	RF RECESSED FLANGED	H835	80 CRI, 3500K, HIGH DOWN ONLY	W MATTE WHITE	I IC	ELV0	ELV/0-10V DIMMING UNV†
			H927	90 CRI, 2700K, HIGH DOWN ONLY			ELD0	ELDOLED 0.1% 0-10V LINEAR UNV†
			H930	90 CRI, 3000K, HIGH DOWN ONLY			ELD0A	ELDOLED 0.1% 0-10V LOGARITHMIC UNV†
			H935	90 CRI, 3500K, HIGH DOWN ONLY			ELD1	ELDOLED 1% 0-10V LINEAR UNV†
			H9WD	90 CRI, WARM DIM 3000-2000K, HIGH DOWN ONLY			ELD1A	ELDOLED 1% 0-10V LOGARITHMIC UNV†
			S835	80 CRI, 3500K, STANDARD DOWN ONLY			HL2W	LUTRON HI-LUME 1% 2 WIRE/PWM*
		RL RECESSED FLANGELESS	S927	90 CRI, 2700K, STANDARD DOWN ONLY	HL2W	LUTRON HI-LUME 1% 2 WIRE/PWM*		
			S930	90 CRI, 3000K, STANDARD DOWN ONLY	HL2W	LUTRON HI-LUME 1% 2 WIRE/PWM*		
			S935	90 CRI, 3500K, STANDARD DOWN ONLY	HL2W	LUTRON HI-LUME 1% 2 WIRE/PWM*		
			S9WD	90 CRI, WARM DIM 3000-2000K, STANDARD DOWN ONLY	HL2W	LUTRON HI-LUME 1% 2 WIRE/PWM*		

\*HL2W - TWO WIRE LOW-VOLTAGE ELECTRONIC DIMMING, 120 VOLT ONLY. †UNV = 120V/277V INPUT VOLTAGE.

## PROJECT INFO

FIXTURE TYPE & QUANTITY	JOB NAME & INFO	NOTES

**ELEMENT**  
by Tech Lighting†

GENERATION BRANDS  
7400 Linder Avenue, Skokie, Illinois 60077  
T 847.410.4400 F 847.410.4500

